

# ASHUTOSH



Ref. No. ....

Date: -15 - 09-2023

To,

**The Authority**  
**WBRERA**  
**Kolkata, West Bengal**

Sir,

The number of open parking areas available in my project "ASHUTOSH APARTMENT" under ASHUTOSH CONSTRUCTION is stated below:

Location	Open	Covered	Mechanical
Basement	-	-	-
Ground Floor	6	-	-
Stilt Floor	-	-	-
Any Other Floor	-	-	-
<b>Total</b>	<b>6</b>	-	-

For, ASHUTOSH CONSTRUCTION

ASHUTOSH CONSTRUCTION

  
Proprietor

**PRANAB KUMAR DE**

+91-9831332191

+91-8910034102

manik.de.75@gmail.com

Lichutala, Bholardabri, 736123



## AREA STATEMENT:

AREA OF LAND: AS PER DEED & MEASUREMENT :  
7K-4CH-7 SFT.(485.62 SQ.M. OR 12 DECIMAL)

- 1) COVERED AREA OF GROUND FLOOR: 253.98 SQ.M.(52.30%)
- 2) COVERED AREA OF 1ST TO 4TH FLOOR: 253.98 SQ.M.
- 3) LEFT OPEN SPACE: 348.03 SQ.M.
- 4)NO OF CAR PARKING :6 NOS
- 5)AREA OF CAR PARKING :103.29 SQ.M.
- 6)AREA OF CARETAKER'S ROOM& SERVICE TOILET:14.15SQ.M.
- 7) VOLUME OF CONSTRUCTION : 3619.22 CU.M.

ASUTOSH DEY SARANI

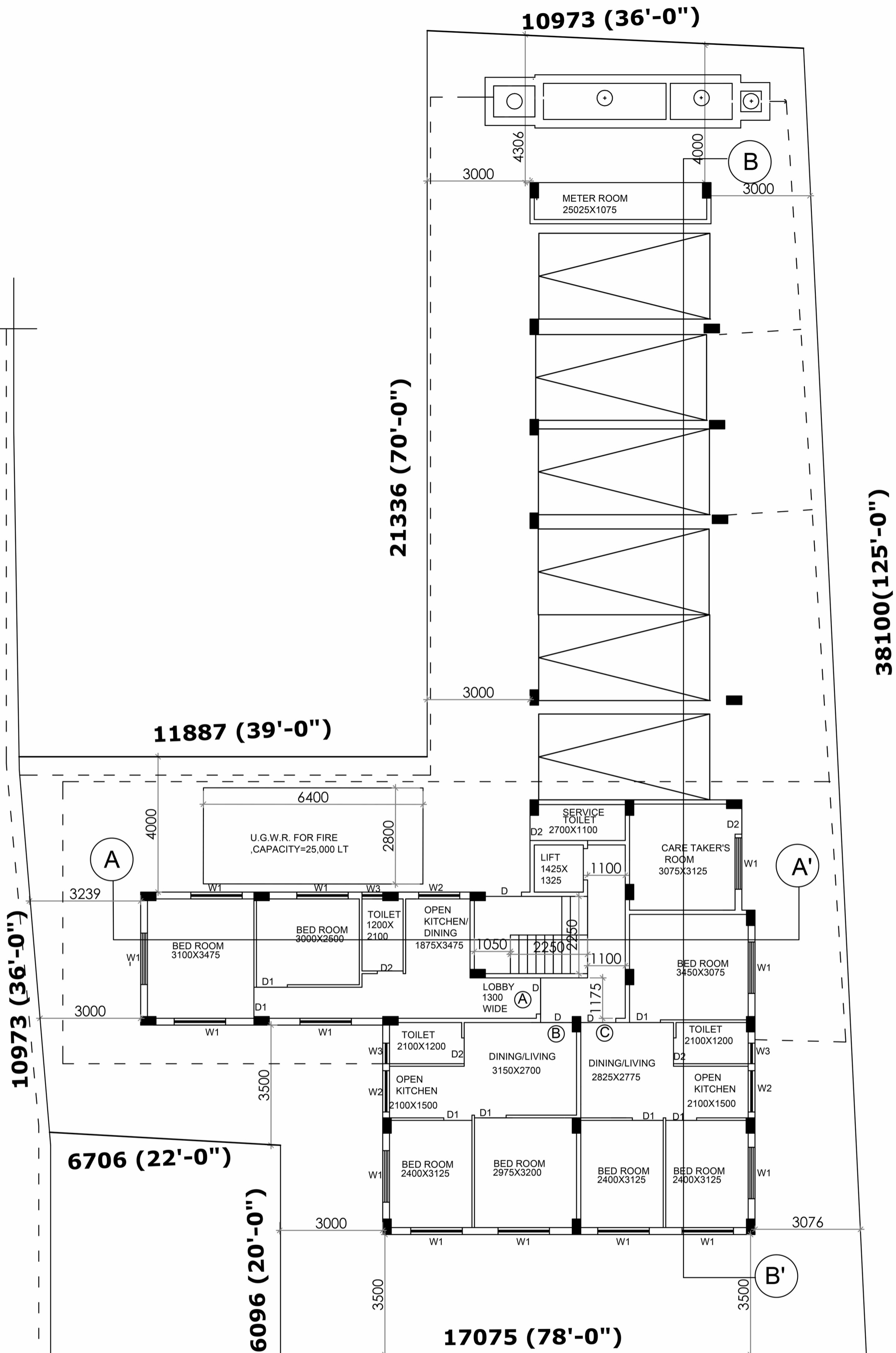

10973 (36'-0")

10973 (36'-0")

21336 (70'-0")

38100 (125'-0")

11887 (39'-0")

6706 (22'-0")

6096 (20'-0")

17075 (78'-0")

MUNICIPALITY DRAIN

B.F. ROAD

GROUND FLOOR PLAN